

SURE TO GROW[®]

The Future of Plant
Growth Media

ROLLS - 20'

Manufactured by Sure to Grow[®] / A division of 6062 Holdings, LLC
23230 Chagrin Boulevard, Beachwood, Ohio 44122
216.360.8116

Soilless Growing Media, Ingredients: PET fiber

1 Grow Roll (STG R)

Dimension of Roll - 20'L x 9.75"W x .35"D

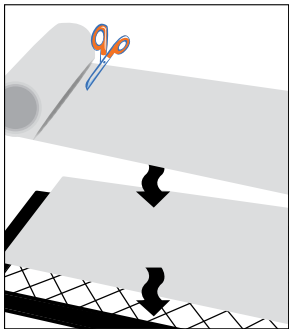

Cut STG Grow Mat[®] to desired size.

OR

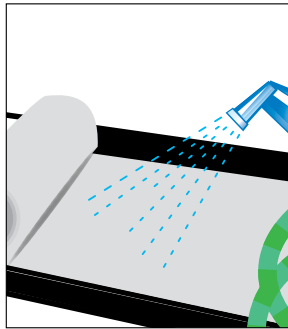

Roll out STG Grow Roll[®] into your growing troughs or trays and saturate them thoroughly.

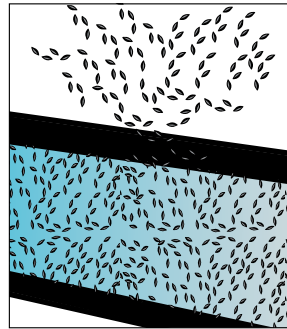

Broadcast seeds onto the surface of the mat at the desired density.

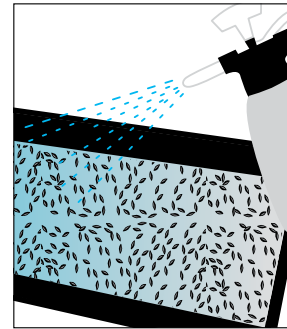

Mist the surface of the mat or pad to settle the seeds into the media.

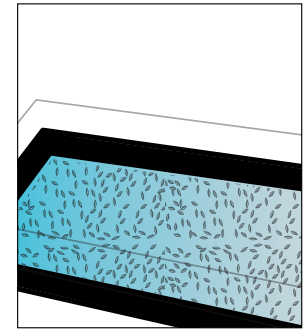

Cover the seeds with a humidity dome or an inverted tray. Mist 2-3 times a day until seeds germinate; then remove cover.

Recommended Crops: Short term crops (less than 21 days) such as microgreens, sprouts and wheatgrass.

For more detailed instructions see **Best Practices for Growing with Sure to Grow[®]**
on the back of this page or go to www.suretogrow.com

Made in U.S.A.

BEST PRACTICES FOR GROWING WITH SURE TO GROW®

Sure to Grow® is a unique media that will give you superior results if you follow our simple instructions:

Which Sure to Grow® product should I use?

Crops	Cubes	Blocks	Slabs	Pads	Rolls	Loose Fill
Cucumbers, Tomatoes, Peppers	✓	✓	✓			✓
Flowers - Cut	✓	✓	✓			✓
Herbs, Baby Greens - Cut	✓	✓	✓			✓
Herbs - Live	✓					✓
Lettuces - Single Head	✓					✓
Microgreens, Sprouts, Wheatgrass				✓	✓	
Ornamentals	✓	✓	✓			✓
Vegetable, Flower Transplants	✓	✓				✓
Other - Rooted Cuttings	✓	✓	✓			✓

Propagating seeds and cuttings with Sure to Grow®

- Completely saturate the Sure to Grow® media.
- Place in free-draining plant trays on a level surface to prevent nutrient run-off and migration; avoid pooling of water at the root zone.
- Deposit seeds into the pre-punched dibble holes; larger seeds and cuttings can be inserted into the cross-cut "x" in the center of the dibble hole.
- After seeding, water the seeds or cuttings gently from the top to establish good contact with the media.
- Cover with a humidity dome or another tray until the seed coat has cracked and the radicle has emerged.
- Keep the media evenly moist during germination. Top watering or flood and drain are the most effective irrigation methods during the germination stage.
- Upon germination, remove the dome and expose seedlings to full light.
- When adjacent seedling leaves are touching, transplant to your growing system. Be sure to completely saturate the roots and cubes at the time of transplanting.

Irrigation

- Once true leaves have emerged it is essential that a complete water-soluble nutrient formulated for the crop be supplied to the plants.
- Compared to other media, STG® will generally require more frequent but shorter irrigation intervals.
- Once plants are placed in the growing system, the irrigation interval must allow the media to stay evenly moist throughout.
- In flood and drain systems, set the flood level to 1/4" to 1/2" below the top surface of the media.
- Should the media dry out, the media needs to be completely rehydrated by flooding and draining or thoroughly watering from the top.

Crop Production

- Vine crops and taller plants may require support in the form of staking or trellising sooner than with other types of media.
- Cover the surface of deeper containers (Bato buckets, Dutch Pots), with a solid cover to block light, preserve moisture and prevent algae growth.

Specific Hydroponic System Instructions

In addition to these Best Practices, please consult our supplemental instructions at www.suretogrow.com for growers using specific hydroponic systems including NFT, Ebb & Flow, Drip, Float, Wick and Aeroponic systems and for growing from cuttings.